

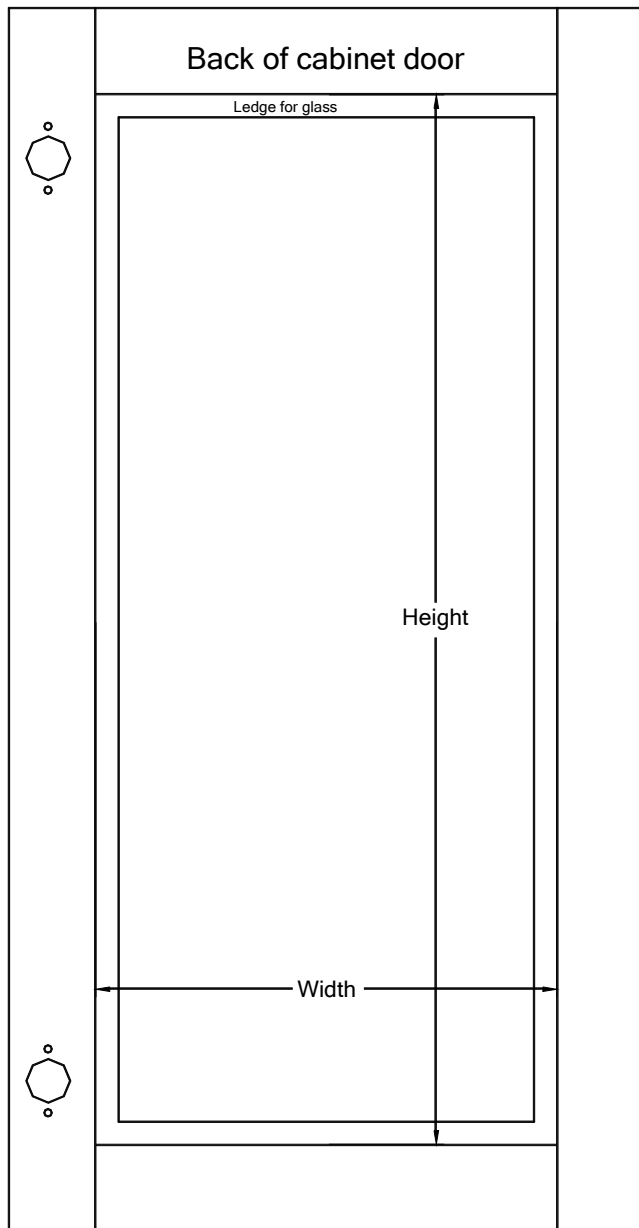

Measuring doors for glass



Measure to the nearest 1/16".

Deduct 1/8" from the exact opening size. This will allow a little room for the glass to fit in the opening properly.

Note: Always record measurements Width x Height. This is important because glass textures run vertically.

Example:
-If the exact opening size is 10-1/4" x 24-3/16"
-Glass order size is 10-1/8" x 24-1/16".